



VERSA RACK INSTALLATION

For Model 4004

A SMALL PARTS LIST:

Part #1 - LOWER MOUNTING BOLT (Qty 2)

Part #2 - WASHERS (Qty 2)

Part #3 - MOUNTING SPACER (Qty 2)

Part #4 - BOLT (Qty 2)

Part #5 - MOUNTING BRACKET (Qty 2)

Part #6 - NUT (Qty 2)

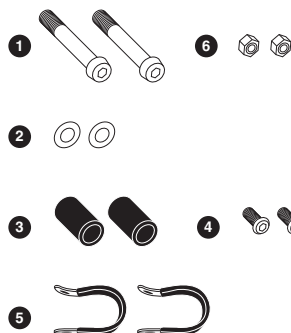

B INSTALLATION

STEP 1.

Mount rack to bike using two **LOWER MOUNTING BOLTS (1)**, two **WASHERS (2)** and two **SPACERS (3)** to secure lower rack mounts of rack to lower mounts on bike.

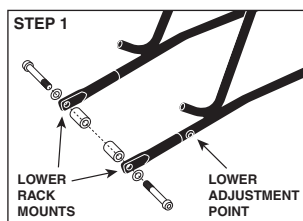

STEP 2.

Mount upper mounts on rack to upper mounts on bike using two **BOLTS (4)** and two **WASHERS (2)**. If bicycle frame does not have rack mounts, **MOUNTING BRACKETS (5)**, **NUTS (6)**, and two **WASHERS (2)** can be used as upper attachment points.

STEP 3.

Use both upper and lower adjustment points to level rack platform.

STEP 4.

Mount reflector or rear light (not included) to **REAR REFLECTOR / LIGHT MOUNT**.

Finish installation by tightening down all adjustment points and mounting hardware.

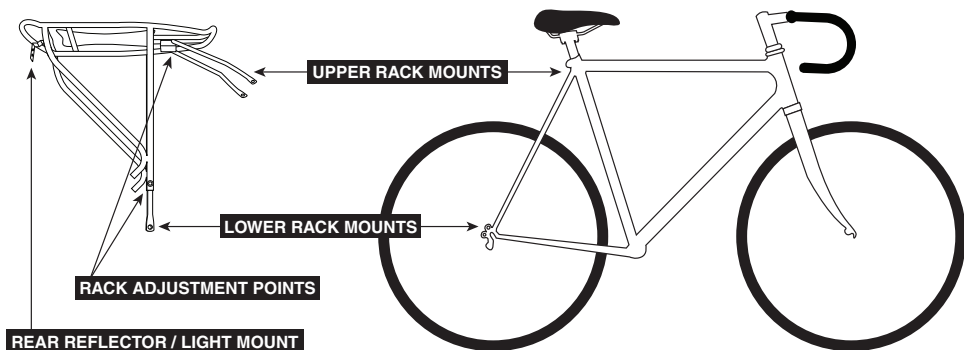

Planet Bike Warranty: We offer a limited lifetime warranty on this product. This includes defects in workmanship and material for the original owner. Warranty does not cover damage due to accident, abuse, or normal wear and tear. Proof of purchase is required. Contact your Planet Bike dealer or Planet Bike.

Planet Bike
2402 Vondron Road
Madison, WI 53718

©2008 Planet Bike. All Rights Reserved.