



SHINER FENDER BRACKET INSTALLATION INSTRUCTIONS



Thanks for buying this Shiner Fender Bracket. It was designed specifically to mount the Shiner Back rear light to your Planet Bike Cascadia ALX fenders. Failure to follow installation instructions can result in loss of control, damage, personal injury or death. If you are unsure of any part of the installation process, please consult a qualified bicycle mechanic or local bike shop. If you have any questions regarding installation of the bracket, feel free to check out the FAQs at www.planetbike.com or email us at info@planetbike.com.

GOOD GEAR GUARANTEE



We offer a two year warranty on this product. This includes defects in workmanship and material for the original owner. Warranty does not cover damage due to accident, abuse, or normal wear and tear. Any modification voids warranty. Proof of purchase is required. Contact your Planet Bike dealer or Planet Bike.

HARDWARE PACK / TOOLS NEEDED

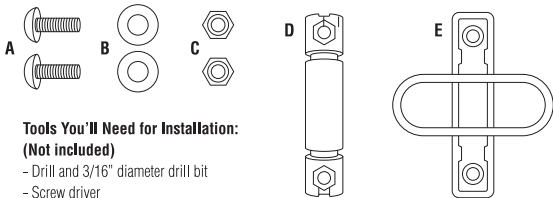

Tools You'll Need for Installation: (Not included)

- Drill and 3/16" diameter drill bit
- Screw driver
- Metal file
- Marker

Parts list:

- A) 12mm bolts (x2)
- B) Washers (x2)
- C) Lock Nuts (x2)
- D) Mounting bracket (x1)
- E) Base pad with straps (x1)

WARNINGS

- Light bracket is designed specifically for Planet Bike Cascadia ALX rear fenders only. Not recommended for plastic fenders or brands other than Planet Bike. Mounting accessories to fenders requires the strength and rigidity of the Cascadia ALX aluminum fenders.
- Failure to follow installation instructions can result in loss of control, damage, personal injury or death.
- Check fender and light installation before each ride to ensure hardware is tight and in good condition and fender is centered over tire with a minimum of 10mm of clearance.
- This light bracket is not intended for off road riding, competitive use, or excessive speeds.
- To keep lights and fenders functioning safely, replace worn parts as needed. Small parts can be found at www.planetbike.com
- If you are unsure of any part of the installation process please consult a certified bicycle mechanic or local bike shop.

* For the most up to date installation instructions, go to www.planetbike.com/

MOUNTING INSTRUCTIONS

STEP 1: Remove Planet Bike ALX rear fender from bike.

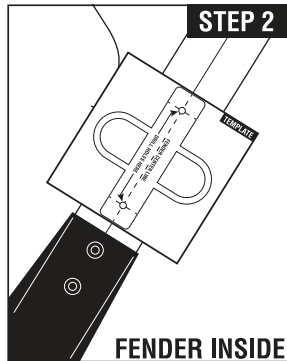
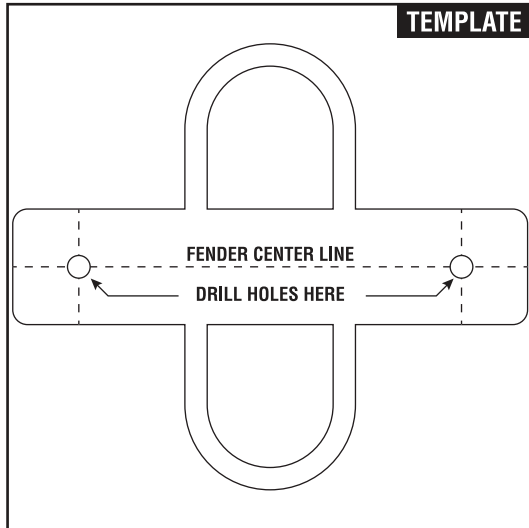

STEP 2: Cut out square template below and mark holes to be drilled on inside surface of fender. Bracket placement should be just above the mud flap on the rear fender only. Be sure to align center line on template with center of fender to ensure the light is positioned straight.

STEP 3: Drill holes in two marked positions with a 3/16" diameter drill bit. De-burr holes, removing any sharp edges with file.

STEP 4: Mount strap and base to fender using the included bolts, washers and lock nuts. Tighten bolts and confirm that bolts fully pass through nylon lock nut.

STEP 5: Reinstall fender on bike according to fender instructions making sure you have a minimum of 10mm of clearance between the tire and all fender parts.

STEP 6: Mount Shiner Back (not included) to bracket.

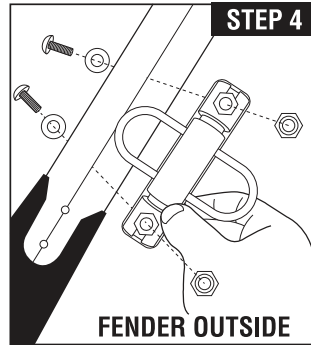

**COME RIDE WITH US.
PLANETBIKE.COM**